

Ball valve AT 3591A



Product information

Fully welded pipe construction with welded end and internal thread. The passage of the ball is restricted by one dimension. Shut-off valve for hot and cold water systems, as well as compressed air and gases. The ball is clamped between two seat rings made of carbon-filled PTFE. All dimensions are equipped with ISO top.



Dimension range (DN)	10 - 50
PN	40
Temperature (°C)	-20 - 200
Main material	Steel

Area of use

Shut-off valve for hot and cold water systems as well as compressed air and gases.

Tender text

PSB.1 Ball valves

Ball valve AT 3591S with lever, DN ... Housing made of steel with one welded end and one internal threaded connection. With spindle neck adapted for over-insulation. ISO top according to 5211.

Quality assurance

AFS 2023:5, PED 2014/68/EU

Product marking: DN, PS, material in load-bearing parts, manufacturing year and month, and AT number are indicated on the valve's nameplate.

Energy and environment declaration

SundaHus: C-

Pos	Component	Material
-----	-----------	----------

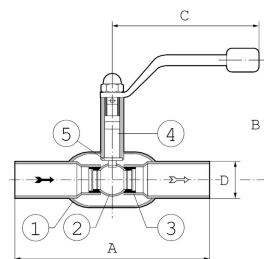

Measurements and weight

Dimension range (DN): 10 - 50

Item number	A	B	C
3591S-010	125	119	
3591S-015	165	119	
3591S-020	175	134	
3591S-025	185	138	
3591S-032	200	142	
3591S-040	220	145	
3591S-050	245	151	

Function and design

Fully welded pipe construction with welded ends, suitable for direct welding into pipe systems. The passage through the ball is restricted by one dimension. The ball is clamped between two PTFE seat rings. The valve is supplied as standard with an ISO top and a high spindle neck for over-insulation. The upper part of the spindle is always visible and inspectable. The valve has a re-tightenable packing box.

Technical data

Main material: Steel

Main material code: Steel P235GH (1.0345)

Included materials: Steel, Other

Included material code: Steel P235GH (1.0345), PTFE (polytetrafluoroethylene)

Temperature (°C): -20 - 200

PN: 40

Connection: ISO 1127, weld end, Internal thread ISO 228-1 (G, BSPP)

ETIM classification: EC011343 - Ball valve

BK04 code: 20702 Ball valves

MagiCAD link: <https://redir.magicad.cloud/product/0d6e07fa-fd8d-45ec-b421-d102b9826d14>

Item number	Temperature (°C)	Temperature (°C)	KVS	Connection 1 - spec.	Connection 2 - spec.	Connection according to ISO 5211	Required torque (Nm)
3591S-010	-20	200	6	DN10-Dy 17,2mm	3/8	F05	3
3591S-015	-20	200	6	DN15-Dy 21,3mm	1/2	F05	3
3591S-020	-20	200	15	DN20-Dy 26,9mm	3/4	F05	4
3591S-025	-20	200	30	DN25-Dy 33,7mm	1	F05	7
3591S-032	-20	200	41	DN32-Dy 42,4mm	1 1/4	F05	16
3591S-040	-20	200	72	DN40-Dy 48,3mm	1 1/2	F05	25
3591S-050	-20	200	104	DN50-Dy 60,3mm	2	F07	48

Installation and maintenance

Flowdirection: Bi-directional

Possible mounting position: Vertical, Horizontal

The valve can be installed in any position, regardless of the direction of the flow of the medium. Welding should be done with the ball in the fully open position. When gas welding, it is especially important to cool the valve housing at the same time so that the seat rings are not damaged. The valve should be operated regularly to avoid the accumulation of dirt that can lead to leakage.

The company's management system
is certified by DNV
ISO 9001 • ISO 14001

Get into the flow

Get into the flow with Armatec.



armatec

info@armatec.se | +46 31 89 01 00 | www.armatec.se