

Butterflyvalve



Product information

High quality valve made of ductile iron with duplex stainless steel disc and has a vulcanised lining for a long product life cycle. The EPDM rubber used in the valve is suitable for hot water, salt water, ammonia water, air, neutral gases, some diluted inorganic acids and some alcohols (max 30%). The connection is flanged according to EN1092. The valve has low torque and low pressure drop. Choose Butterfly Valve AT 2313B for reliable and efficient operation.

Dimension range (DN)	40 - 800
PN	16
Temperature (°C)	-20 - 110
Main material	Ductile iron

Area of use

This product is of the highest quality and is designed to withstand pressure class PN16 and temperatures ranging from -20 to 110 °C. It is developed to fit within the dimensional range (DN, liters) from 40 to 600. With this product, you can be sure that you are getting a reliable and robust solution for your needs.

For shut-off and regulation of:

- Hot and cold water:
- Heating and cooling systems
- Water-glycol mixtures
- Water with some oil content
- Saltwater, brackish water
- Vacuum
- Neutral gases

EPDM rubber: Hot water, air, neutral gases, some diluted inorganic acids, some alcohols (max 30%).

Tender text

PSB.2 Rotary butterfly valves

Butterfly valve AT 2313B, with a cast iron body and a fixed vulcanized EPDM liner in the body, as well as a duplex stainless steel disc.

AT 2313BS with lever standard up to DN150,

AT 2313BV with gearbox standard from DN150.

Quality assurance

AFS 2023:5, PED 2014/68/EU

The product is CE marked

Product marking: Model, DN, Flange, Bodymaterial, Seat material, Disc material, PS, TS, PT, date of test, serialnumber, standard and AT-number

Energy and environment declaration

Reach date: 6/14/2023 12:00:00 AM

Measurements and weight

Dimension range (DN): 40 - 800

Item number	A	B	C	D	E	F	G	H	Net weight (kg)
130444	40	86	33	58	113	12	34	10	3
130445	50	100	43	63	118	12	34	10	4
130446	65	115	46	71	126	12	34	10	5
130447	80	130	46	78	133	12	34	10	5
130448	100	150	52	98	147	12	34	12	6
130449	125	182	56	109	160	12	34	12	9
130450	150	210	56	133	180	14	34	16	10
134189	40	86	33	58	113	12	15	9	2
129423	50	100	43	63	118	12	15	9	3
129424	65	115	46	71	126	12	15	9	4
129425	80	130	46	78	133	12	15	9	4
129426	100	150	52	98	147	12	15	11	5
129427	125	182	56	109	160	12	16	14	8
129428	150	210	56	133	180	14	16	14	9
129429	200	262	60	158	204	14	19	17	14
129430	250	315	68	194	245	15	24	22	23
129431	300	371	78	219	270	15	24	22	35
129432	336	405	78	236	315	15	24	22	0

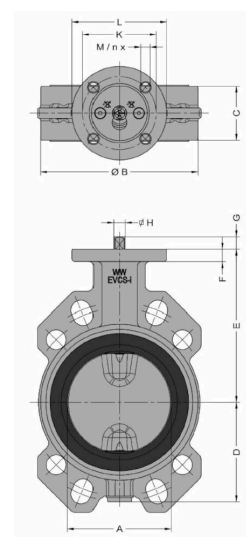

Function and design

Fully sealed maintenance-free butterfly valve with a centrally located disc, split spindle, and a completely housed body with in-house vulcanized rubber lining that eliminates the risk of gap corrosion, protects the valve body internally against corrosion, and serves as a flange gasket. The manufacturing process ensures excellent sealing and increased lifespan as wear of the lining is eliminated. The profile of the disc is crucial to achieving good flow characteristics, which ultimately leads to minimizing energy losses. The valve is tight regardless of the flow

direction.

Valve body with semi-LUG mounting ears for one-sided installation. AT 2313B is equipped with mounting ears up to DN 350. Hole pattern DN40-DN350 fits flanges PN6/PN10/PN16 and CL150. Construction length according to SS-EN 558, series 20. Top flange according to ISO 5211.

Standard surface treatment class C3 according to ISO 12944.

For outdoor installation where there are significant amounts of air pollution or moderate amounts of salt, such as in industrial and coastal areas, without rain protection, class C4 is recommended.

Technical data

Main material: Ductile iron

Main material code: Ductile iron GJS-400-15 (GGG40)

Included materials: Ductile iron, Stainless steel, Rubber

Included material code: EPDM (ethylene propylene diene monomer rubber), Stainless steel (1.4470)

Temperature (°C): -20 - 110

PN: 16

Connection: Flanged EN1092

ETIM classification: EC010910 - Butterfly valve

BK04 code: 20706 Single-leaf dampers

Product colour: RAL 2000 - Yellow orange

Technical data

Item number	KVS	Connection according to ISO 5211	Stem measurments	Required torque (Nm)	Leakagerate
130444	95	F07	10x10mm	4	Rate A acc. to EN 12266-1:2012
130445	95	F07	10x10mm	6	Rate A acc. to EN 12266-1:2012
130446	231	F07	10x10mm	10	Rate A acc. to EN 12266-1:2012
130447	491	F07	10x10mm	16	Rate A acc. to EN 12266-1:2012
130448	690	F07	12x12mm	29	Rate A acc. to EN 12266-1:2012
130449	1450	F07	12x12mm	45	Rate A acc. to EN 12266-1:2012
130450	1945	F07	16x16mm	65	Rate A acc. to EN 12266-1:2012
134189	95	F07	9x9mm	4	Rate A acc. to EN 12266-1:2012
129423	95	F07	9x9mm	6	Rate A acc. to EN 12266-1:2012

Item number	KVS	Connection according to ISO 5211	Stem measurments	Required torque (Nm)	Leakagerate
129424	231	F07	9x9mm	10	Rate A acc. to EN 12266-1:2012
129425	491	F07	9x9mm	16	Rate A acc. to EN 12266-1:2012
129426	690	F07	11x11mm	29	Rate A acc. to EN 12266-1:2012
129427	1450	F07	14x14mm	45	Rate A acc. to EN 12266-1:2012
129428	1945	F07	14x14mm	65	Rate A acc. to EN 12266-1:2012
129429	4095	F07	17x17mm	141	Rate A acc. to EN 12266-1:2012
129430	6085	F10	22x22mm	276	Rate A acc. to EN 12266-1:2012
129431	9570	F10	22x22mm	394	Rate A acc. to EN 12266-1:2012
129432		F12	22x22mm	478	

Installation and maintenance

Flowdirection: Bi-directional

Possible mounting position: Vertical, Horizontal

Possible mounting position notes: The stem should not be mounted so that it is pointing downwards as this may cause leakage.

The valve is intended to be mounted between flanges, without gaskets, and where possible with the shafts in a horizontal position, avoid mounting the valve with the shaft downwards. In case of unilateral mounting, bolts and nuts shall not be tightened with a higher torque than specified in the table of the relevant standard. The valve should be exercised regularly to avoid the accumulation of dirt that can lead to leakage.

The company's management system
is certified by Kiwa
ISO 9001 • ISO 14001

Get into the flow

Get into the flow with Armatec.



armatec

post@armatec.no | +47 23 24 55 00 | www.armatec.no