

Product information

Fully welded pipe construction with welded ends, the ball is fully closed. Designed for direct welding into pipe systems. Shut-off valve for hot and cold water systems as well as compressed air and gases. The ball is clamped between two seat rings of carbon-filled PTFE. All dimensions are equipped with ISO tops.

Dimension range (DN)	10 - 300
PN	25 - 40
Temperature (°C)	-20 - 160
Main material	Steel

Area of use

Shut-off valve for hot and cold water systems as well as compressed air and gases. Full open.

Tender text

PSB.1 Ball valves

For DN 15-150 with lever; Ball valve AT 3594S, DN ... Steel body with welded ends. With high spindle neck for over-insulation. Full bore.

For DN 100-400 with gearbox; Ball valve AT 3594V, DN ... Steel body with welded ends. With high spindle neck for over-insulation. Full bore.

Ball valve AT 3591S with lever, DN ... Steel body with one welded end and one internal threaded connection. With spindle neck adapted for over-insulation.

Quality assurance

AFS 2023:5, PED 2014/68/EU

Product marking: DN, PS, material in pressure-bearing parts, manufacturing year and month, and AT number are indicated on the valve's nameplate.

Pos	Component	Material
-----	-----------	----------

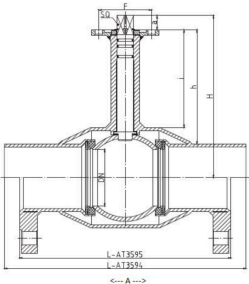

Measurements and weight

Dimension range (DN): 10 - 300

Function and design

Fully welded pipe construction with welded ends, suitable for direct welding into pipe systems. The ball is fully enclosed. The ball is clamped between two PTFE seat rings. The valve is supplied as standard with an ISO top and a high spindle neck for over-insulation. The upper part of the spindle is always visible and inspectable.

Technical data

- Main material: Steel
- Included materials: Stainless steel, Steel, Other
- Included material code: Stainless steel AISI 304 (1.4301), PTFE (polytetrafluoroethylene)
- Temperature (°C): -20 - 160
- PN: 25 - 40
- Connection: ISO 1127, weld end
- ETIM classification: EC011343 - Ball valve
- BK04 code: 20702 Ball valves
- Product colour: RAL 5005 - Signal blue

Item number	3594S-015	3594S-040	3594S-050	3594S-065	3594S-080	3594V-150	3594V-200	3594V-300	3594-400
KVS									
Execution									
Connection 1 - spec.	DN15-Dy 21,3mm	DN40-Dy 48,3mm	DN50-Dy 60,3mm	DN65-Dy 76,1mm	DN80-Dy 88,9mm	DN150-Dy 168,3mm	DN200-Dy 219,1mm	DN300-Dy 323,9mm	PN25
Connection 2 - spec.	DN15-Dy 21,3mm	DN40-Dy 48,3mm	DN50-Dy 60,3mm	DN65-Dy 76,1mm	DN80-Dy 88,9mm	DN150-Dy 168,3mm	DN200-Dy 219,1mm	DN300-Dy 323,9mm	PN25
Connection according to ISO 5211									
Stem measurements									

Item number	3594S-015	3594S-040	3594S-050	3594S-065	3594S-080	3594V-150	3594V-200	3594V-300	3594-400
-------------	-----------	-----------	-----------	-----------	-----------	-----------	-----------	-----------	----------

Required torque (Nm)

Installation and maintenance

Flowdirection: Bi-directional
Possible mounting position: Vertical, Horizontal

The valve can be installed in any position, regardless of the direction of the medium flow. Welding should be done with the ball in the fully open position. When gas welding, it is especially important to cool the valve housing at the same time so that the seat rings are not damaged.

Please feel free to contact us

We answer your questions by e-mail and telephone. No question is too small, no challenge is too big. You are always welcome at Armatec.

info@armatec.se | +46 31 89 01 00 | www.armatec.se

THE COMPANY'S MANAGEMENT SYSTEM
IS CERTIFIED BY DNV
ISO 9001 • ISO 14001