

# Ball valve AT 3545-

\*\*\*\*  
PRESTERA™



## Product information

Ball valve with full passage made of steel/CPTFE with welded ends and mounting flange for actuator. Suitable for automation. Three-piece for easy service and maintenance. Primarily for steam, gas, hot and cold water.

<b>Dimension range (DN)</b>	10 - 100
<b>PN</b>	64 - 125
<b>Temperature (°C)</b>	-28 - 220
<b>Main material</b>	Steel

### Area of use

Shut-off valve primarily for:

- Petroleum products
- Hot and cold water as well as compressed air
- Saturated steam

### Tender text

#### PSB.1 Ball valves

Steel ball valve AT 3545..., with full bore, welded ends, and steel handle. Packing made of carbon-filled PTFE.

### Quality assurance

AFS 2023:5, PED 2014/68/EU

**The product is CE marked**

**Product marking:** Manufacturer, DN, PN, material code, CE. If applicable, also indicate flow direction.

### Energy and environment declaration

**Subject to notification under REACH:** No

**Reach date:** 12/06/2026

**Pos**                      **Component**                      **Material**

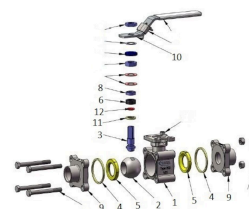

## Measurements and weight

**Dimension range (DN):** 10 - 100

DN	A	B	C	D	F	G	Net weight (kg)
10	75	75	140	42.6	10	24.5	0.8
15	75	76.6	140	42.6	15	24.5	0.9
20	90	81.7	140	46.8	20	31.4	1.4
25	110	98.3	170	59.3	25	41.3	2.1
32	115	101.6	170	62.6	32	48.4	2.9
40	130	128	230	79	38	56.3	4.4
50	143	137	230	87.7	50	71.4	4.5
65	185	167.5	380	108.7	65	86.6	11.3
80	205	176.5	520	117.7	80	99	14.8
100	240	192.5	520	133.7	100	127	23.3

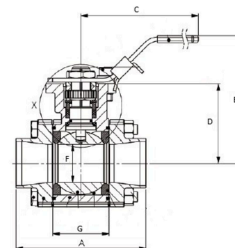

## Function and design

Three-piece ball valve for easy service and maintenance.  
 Homogeneous liquid ball for tight shut-off and low pressure drop.  
 Self-compensating spindle packing provides a tight valve at high operating frequencies.  
 Blow-out safe antistatic spindle construction prevents the spindle from being pushed out during pressure surges.  
 Mounting flange according to ISO 5211 for actuators.  
 No valve disassembly required for service and installation of actuators.  
 Valves larger than DN50 have a round valve body/mounting flange.

## Technical data

**Main material:** Steel

**Main material code:** Steel GP240GH N (1.0619)

**Included materials:** Stainless steel, Steel, Other

**Included material code:** Acid resistant stainless steel AISI 316 (1.4401), Steel GP240GH N (1.0619)

**Temperature (°C):** -28 - 220

**PN:** 64 - 125

**Connection:** ASTM A53, Schedule 40

**ETIM classification:** EC011343 - Ball valve

**BK04 code:** 20702 Ball valves

**Comment to colour:** Black

Item number	KVS	Execution	Connection 1	Connection 1 - spec.	Connection 2	Connection 2 - spec.	Connection according to ISO 5211	Stem measurements
3545-10	6.9	Full bore	ASTM A53, Schedule 40	DN10-Dy 17,5mm	ASTM A53, Schedule 40	DN10-Dy 17,5mm	F03/F04	9x9mm
3545-15	12.7	Full bore	ASTM A53, Schedule 40	DN15-Dy 21,7mm	ASTM A53, Schedule 40	DN15-Dy 21,7mm	F03/F04	9x9mm
3545-20	29.2	Full bore	ASTM A53, Schedule 40	DN20-Dy 27,2mm	ASTM A53, Schedule 40	DN20-Dy 27,2mm	F03/F04	9x9mm
3545-25	48.2	Full bore	ASTM A53, Schedule 40	DN25-Dy 34mm	ASTM A53, Schedule 40	DN25-Dy 34mm	F04/F05	11x11mm
3545-32	73.1	Full bore	ASTM A53, Schedule 40	DN32-Dy 42,7mm	ASTM A53, Schedule 40	DN32-Dy 42,7mm	F04/F05	11x11mm
3545-40	107.5	Full bore	ASTM A53, Schedule 40	DN40-Dy 48,6mm	ASTM A53, Schedule 40	DN40-Dy 48,6mm	F05/F07	14x14mm
3545-50	215	Full bore	ASTM A53, Schedule 40	DN50-Dy 60,5mm	ASTM A53, Schedule 40	DN50-Dy 60,5mm	F05/F07	14x14mm
3545-65	275.2	Full bore	ASTM A53, Schedule 40	DN65-Dy 76,6mm	ASTM A53, Schedule 40	DN65-Dy 76,6mm	F07/F10	17x17mm
3545-80	498.8	Full bore	ASTM A53, Schedule 40	DN80-Dy 88,9mm	ASTM A53, Schedule 40	DN80-Dy 88,9mm	F07/F10	17x17mm
3545-100	877.2	Full bore	ASTM A53, Schedule 40	DN100-Dy 114,3mm	ASTM A53, Schedule 40	DN100-Dy 114,3mm	F07/F10	17x17mm

## Installation and maintenance

**Flowdirection:** Bi-directional

**Possible mounting position:** Vertical, Horizontal

The valve should be regularly exercised to avoid the accumulation of dirt that can lead to leakage.

The company's management system  
is certified by DNV  
ISO 9001 • ISO 14001

# Get into the flow

Get into the flow with Armatec.



**armatec**

info@armatec.se | +46 31 89 01 00 | www.armatec.se