



Product information

Brass ball valve, full bore, PN 25, with internal and external threads and steel handle. Graphite packing. Suitable for heating, cooling, air and gas systems. Can also be used for vacuum and lighter oils.

Dimension range (DN)	10 - 50
PN	40
Temperature (°C)	0 - 150
Main material	Brass



Area of use

Shut-off valve for heating, cooling, air, and gas systems. Can also be used for vacuum and lighter oils, see also section "Installation". Silicone-free.

Tender text

PSB.1 Ball valves

Brass ball valve AT 3640, G... with full bore, internal and external thread, and steel handle. Graphite packing.

Quality assurance

AFS 2023:5, 8 paragraf

Product marking: Brand and DN.

Energy and environment declaration

Product Bvb: Avoided

Product BVB ID: 52753

SundaHus: C-

Subject to notification under REACH

Reach date: 9/23/2024 11:58:00 AM

Item number	SCIP number
3640-10	b9c440fa-966d-4c25-a44c-2d1b1239ca91
3640-15	b9c440fa-966d-4c25-a44c-2d1b1239ca91
3640-20	b9c440fa-966d-4c25-a44c-2d1b1239ca91
3640-25	b9c440fa-966d-4c25-a44c-2d1b1239ca91
3640-32	b9c440fa-966d-4c25-a44c-2d1b1239ca91
3640-40	b9c440fa-966d-4c25-a44c-2d1b1239ca91
3640-50	b9c440fa-966d-4c25-a44c-2d1b1239ca91

Pos	Component	Material
-----	-----------	----------

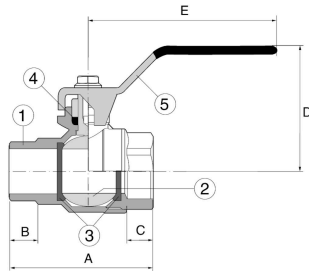

Measurements and weight

Dimension range (DN): 10 - 50

DN	A	B	C	D	Net weight (kg)
10	47	10	9	41	0.12
15	56	12	12	53	0.22
20	65	12	12	57	0.31
25	76	16	15	65	0.53
32	91	18	16	71	0.83
40	105	19	17	79	1.27
50	122	21	19	87	1.9

Function and design

AT 3640 has a so-called "blow-out safe" spindle. The valves have full passage.

Technical data

Main material: Brass

Main material code: Brass (CuZn40Pb2) (CW617N) (2.0402)

Included materials: Brass, Steel, Other

Included material code: Brass CuZn39Pb2 (CW612N), Brass (CuZn40Pb2) (CW617N) (2.0402)

Temperature (°C): 0 - 150

Temperature notes: For air -10C

PN: 40

Connection: Internal thread ISO 228-1 (G, BSPP), External thread ISO 228-1 (G, BSPP)

ETIM classification: EC011343 - Ball valve

BK04 code: 20702 Ball valves

Item number	KVS	Connection 1	Connection 1 - spec.	Connection 2	Connection 2 - spec.
3640-10	5.8	Internal thread ISO 228-1 (G, BSPP)	3/8	External thread ISO 228-1 (G, BSPP)	3/8
3640-15	15.7	Internal thread ISO 228-1 (G, BSPP)	1/2	External thread ISO 228-1 (G, BSPP)	1/2
3640-20	30.8	Internal thread ISO 228-1 (G, BSPP)	3/4	External thread ISO 228-1 (G, BSPP)	3/4
3640-25	49.3	Internal thread ISO 228-1 (G, BSPP)	1	External thread ISO 228-1 (G, BSPP)	1
3640-32	79	Internal thread ISO 228-1 (G, BSPP)	1 1/4	External thread ISO 228-1 (G, BSPP)	1 1/4
3640-40	125.3	Internal thread ISO 228-1 (G, BSPP)	1 1/2	External thread ISO 228-1 (G, BSPP)	1 1/2
3640-50	224.2	Internal thread ISO 228-1 (G, BSPP)	2	External thread ISO 228-1 (G, BSPP)	2

Installation and maintenance

Flowdirection: Bi-directional

Possible mounting position: Vertical, Horizontal

The valves have internal/external pipe threads.

Tightening of the packing may be necessary for air and gas systems when the test pressure exceeds 6 bar. The valve should be exercised regularly to avoid the accumulation of dirt that can lead to leakage.

Please feel free to contact us

We answer your questions by e-mail and telephone. No question is too small, no challenge is too big. You are always welcome at Armatec.

info@armatec.se | +46 31 89 01 00 | www.armatec.se

THE COMPANY'S MANAGEMENT SYSTEM
IS CERTIFIED BY DNV
ISO 9001 • ISO 14001