

# Butterfly valve AT 2313-



## Product information

High-quality fully-sealed butterfly valve with a duplex disc and a fixed vulcanized EPDM rubber liner. Semi-LUG design. Also suitable for vacuum and as an end valve with a hand lever, worm gear, or actuator.



<b>Dimension range (DN)</b>	50 - 2200
<b>PN</b>	10 - 16
<b>Temperature (°C)</b>	-20 - 110
<b>Main material</b>	Cast iron

### Area of use

For shut-off and regulation. Hot and cold water:

- Heating and cooling systems
- Glycol-mixed water
- Greywater
- Vacuum
- Neutral gases

EPDM rubber: Hot water, air, neutral gases, some diluted inorganic acids, some alcohols (max 30%)

EPDM high temp: Cooling and heating water with an extended temperature range, -30°C to 130°C.

### Tender text

#### PSB.2 Rotary butterfly valves

Butterfly valve AT 2313, with a gray iron body and a fixed vulcanized EPDM liner in the body, as well as a disc made of acid-resistant duplex steel.

AT 2313S with standard lever up to DN150,

AT 2313V with standard gearbox from DN200.

### Quality assurance

AFS 2023:5, PED 2014/68/EU

**The product is CE marked**

**Product marking:** Brand, DN, PN, material according to SS-EN 23.

## Energy and environment declaration

**Product Bvb:** Avoided

**Product BVB ID:** 53285

**Subject to notification under REACH:** No

**Reach date:** 12/06/2026

Pos	Component	Material
1	Valve body	Cast iron GJL-250 (GG25)

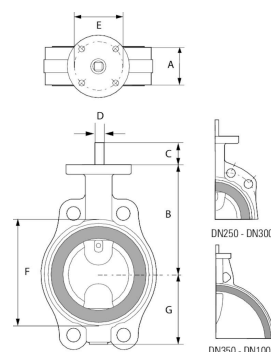

## Measurements and weight

Dimension range (DN): 50 - 2200

DN	A	B	C	Net weight (kg)
50	43	118	63	3.808
65	46	126	71	4.595
80	46	133	78	4.774
100	52	147	98	6.119
125	56	160	109	8
150	56	180	133	10.2
200	60	204	158	16
250	68	245	194	28.5
300	78	270	219	35.2
350	78	315	236	46
400	102	363	308	84
450	114	388	334	86
500	127	413	360	130
600	154	510	426	175

## Function and design

Fully sealed maintenance-free butterfly valve with a centrally located disc, split spindle, and a completely housed body with in-house vulcanized rubber lining that eliminates the risk of gap corrosion, protects the valve body

internally against corrosion, and serves as a flange gasket. The manufacturing process ensures excellent sealing and increased lifespan as wear of the lining is eliminated. The disc profile is crucial to achieving good flow characteristics, which ultimately leads to minimizing energy losses. The valve is tight regardless of the flow direction.

Valve body with SEMI-LUG mounting ears for one-sided installation

AT 2313 is equipped with mounting ears up to DN 200.

This design ensures that the valve maintains its sealing function even with one-sided flange mounting, such as at the end of a pipeline.

The disc and shafts are connected with one or more strong tapered pins.

Top flange according to ISO 5211.

Standard surface treatment class C3 according to ISO 12944.

For outdoor installation where there are significant amounts of air pollution or moderate amounts of salt, such as in industrial and coastal areas, without rain protection, class C4 is recommended.

## Technical data

**Main material:** Cast iron

**Main material code:** Cast iron GJL-250 (GG25)

**Included materials:** Cast iron, Stainless steel, Rubber

**Included material code:** Stainless steel duplex (1.4462), Cast iron GJL-250 (GG25), EPDM (ethylene propylene diene monomer rubber)

**Temperature (°C):** -20 - 110

**PN:** 10 - 16

**Connection:** Flanged EN1092

**ETIM classification:** EC010910 - Butterfly valve

**BK04 code:** 20706 Single-leaf dampers

**Product colour:** RAL 2000 - Yellow orange

## Installation and maintenance

**Flowdirection:** Bi-directional

**Possible mounting position:** Vertical, Horizontal

**Possible mounting position notes:** "Mounting with a horizontal spindle axis is optimal."

The valve is intended to be mounted between flanges, without gaskets, and where possible with the shafts in a horizontal position. Avoid mounting the valve with the shaft downwards. In the case of one-sided mounting, bolts and nuts should not be tightened with a higher torque than specified in the table in the relevant standard. The valve should be operated regularly to avoid the accumulation of dirt that can lead to leakage.

The company's management system  
is certified by DNV  
ISO 9001 • ISO 14001

# Get into the flow

Get into the flow with Armatec.

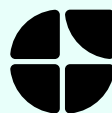

**armatec**

info@armatec.se | +46 31 89 01 00 | www.armatec.se