

Product information

Fully welded pipe construction with welded ends, the ball is fully closed. Designed for direct welding into pipe systems. Shut-off valve for hot and cold water systems as well as compressed air and gases. The ball is clamped between two seat rings of carbon-filled PTFE. All dimensions are equipped with ISO tops.

| | |
|----------------------|-----------|
| Dimension range (DN) | 10 - 300 |
| PN | 25 - 40 |
| Temperature (°C) | -20 - 160 |
| Main material | Steel |

Area of use

Shut-off valve for hot and cold water systems as well as compressed air and gases. Full open.

Tender text

PSB.1 Ball valves

For DN 15-150 with lever; Ball valve AT 3594S, DN ... Steel body with welded ends. With high spindle neck for over-insulation. Full bore.

For DN 100-400 with gearbox; Ball valve AT 3594V, DN ... Steel body with welded ends. With high spindle neck for over-insulation. Full bore.

Ball valve AT 3591S with lever, DN ... Steel body with one welded end and one internal threaded connection. With spindle neck adapted for over-insulation.

Quality assurance

AFS 2023:5, PED 2014/68/EU

Product marking: DN, PS, material in pressure-bearing parts, manufacturing year and month, and AT number are indicated on the valve's nameplate.

| Pos | Component | Material |
|-----|-----------|----------|
|-----|-----------|----------|

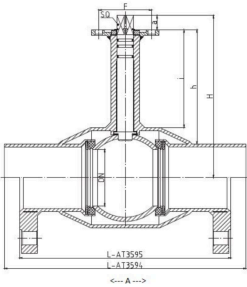

Measurements and weight

Dimension range (DN): 10 - 300

Function and design

Fully welded pipe construction with welded ends, suitable for direct welding into pipe systems. The ball is fully enclosed. The ball is clamped between two PTFE seat rings. The valve is supplied as standard with an ISO top and a high spindle neck for over-insulation. The upper part of the spindle is always visible and inspectable.

Technical data

- Main material:** Steel
- Main material code:** Stainless steel AISI 304 (1.4301), PTFE (polytetrafluoroethylene)
- Included materials:** Stainless steel, Steel, Other
- Included material code:** Stainless steel AISI 304 (1.4301), PTFE (polytetrafluoroethylene)
- Temperature (°C):** -20 - 160
- PN:** 25 - 40
- Connection:** ISO 1127, weld end
- ETIM classification:** EC011343 - Ball valve
- BK04 code:** 20702 Ball valves
- Product colour:** RAL 5005 - Signal blue

Installation and maintenance

- Flowdirection:** Bi-directional
- Possible mounting position:** Vertical, Horizontal

The valve can be installed in any position, regardless of the direction of the medium flow. Welding should be done with the ball in the fully open position. When gas welding, it is especially important to cool the valve housing at the same time so that the seat rings are not damaged.

Please feel free to contact us

We answer your questions by e-mail and telephone. No question is too small, no challenge is too big. You are always welcome at Armatec.

info@armatec.se | +46 31 89 01 00 | www.armatec.se

THE COMPANY'S MANAGEMENT SYSTEM
IS CERTIFIED BY DNV
ISO 9001 • ISO 14001