



Product information

Ball valve in dezincification-resistant brass with a low neck, full bore, internal thread, and steel handle for hot and cold water. Can also be used for vacuum and lighter oils (such as diesel). Graphite packing. 3606 has an extended high neck.

Dimension range (DN)	10 - 50
PN	40
Temperature (°C)	0 - 150
Main material	Brass



## Area of use

Shut-off valve for hot and cold water. Can also be used for air, vacuum, and lighter oils (such as diesel). Silicone-free.

For water, refrigeration, and heating systems (fluid group 2), the temperature range is -0°C to +110°C. Not suitable for drinking water!

For flammable liquids, the maximum pressure is 16 bar.

## Tender text

### **PSB.1 Ball valves**

Ball valve in dezincification-resistant brass AT 3605, G... With full passage, internal thread, and steel handle. PN 16. Graphite packing and PTFE-coated ball.

## Quality assurance

AFS 2023:5, 8 paragraf

**Product marking:** Brand and DN.

## Energy and environment declaration

**Product Bvb:** Avoided

**Product BVB ID:** 8548

**SundaHus:** C-

**Subject to notification under REACH**

**Reach date:** 9/23/2024 11:58:00 AM

Item number	SCIP number
3605-10	b9c440fa-966d-4c25-a44c-2d1b1239ca91
3605-15	b9c440fa-966d-4c25-a44c-2d1b1239ca91
3605-20	b9c440fa-966d-4c25-a44c-2d1b1239ca91
3605-25	b9c440fa-966d-4c25-a44c-2d1b1239ca91
3605-32	b9c440fa-966d-4c25-a44c-2d1b1239ca91
3605-40	b9c440fa-966d-4c25-a44c-2d1b1239ca91
3605-50	b9c440fa-966d-4c25-a44c-2d1b1239ca91
3605V40	b9c440fa-966d-4c25-a44c-2d1b1239ca91
3605V50	b9c440fa-966d-4c25-a44c-2d1b1239ca91

Pos	Component	Material
-----	-----------	----------

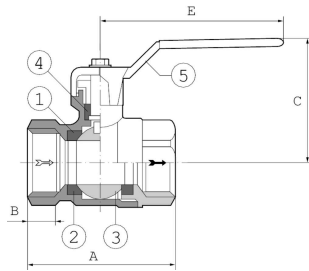

Measurements and weight

Dimension range (DN): 10 - 50

DN	A	B	Net weight (kg)
10			0.117
15			0.223
20			0.303
25			0.513
32			0.821
40			1.402

DN	A	B	Net weight (kg)
50			2.234

## Function and design

AT 3605 has a so-called "blow-out safe" spindle. AT 3605V is equipped with a slow-closing handle. AT 3606 has an aluminum spindle extension mounted.

## Technical data

**Main material:** Brass

**Main material code:** Brass (CuZn36Pb2As) (CW602N)

**Included materials:** Brass, Steel, Other

**Included material code:** Brass (CuZn36Pb2As) (CW602N), PTFE (polytetrafluoroethylene)

**Temperature (°C):** 0 - 150

**PN:** 40

**Connection:** Internal thread ISO 228-1 (G, BSPP)

**ETIM classification:** EC011343 - Ball valve

**BK04 code:** 20702 Ball valves

**MagiCAD link:** <https://redir.magicad.cloud/product/3c138e61-ec7a-4403-ad9d-8c7e2a6af317>

## Installation and maintenance

**Flowdirection:** Bi-directional

**Possible mounting position:** Vertical, Horizontal

"All valves have internal pipe threads. Tightening of the packing may be necessary for air and gas systems when the test pressure exceeds 6 bar (e). For optimal function, the valve should be operated at least 2 times per year."

### Please feel free to contact us

We answer your questions by e-mail and telephone. No question is too small, no challenge is too big. You are always welcome at Armatec.

[info@armatec.se](mailto:info@armatec.se) | +46 31 89 01 00 | [www.armatec.se](http://www.armatec.se)

THE COMPANY'S MANAGEMENT SYSTEM  
IS CERTIFIED BY DNV  
ISO 9001 • ISO 14001