

# Ball valve AT 3565-

\*\*\*  
PRESTERA™



## Product information

Ball valve with full passage made of steel/CPTFE with internal threads and mounting flange for actuator. Suitable for automation. Three-piece for easy service and maintenance. Primarily for steam, gas, hot and cold water.

<b>Dimension range (DN)</b>	10 - 50
<b>PN</b>	64 - 125
<b>Temperature (°C)</b>	-28 - 220
<b>Main material</b>	Steel

### Area of use

Shut-off valve primarily for:

- Petroleum products
- Hot and cold water as well as compressed air
- Saturated steam

### Tender text

#### PSB.1 Ball valves

Steel ball valve AT 3565..., with full bore, internal thread, and steel handle. Packing made of carbon-filled PTFE.

### Quality assurance

AFS 2023:5, PED 2014/68/EU

**The product is CE marked**

**Product marking:** Manufacturer, DN, PN, material code, CE. If applicable, also include flow direction.

### Energy and environment declaration

**Subject to notification under REACH:** No

**Reach date:** 15/04/2026

**Pos**                      **Component**                      **Material**

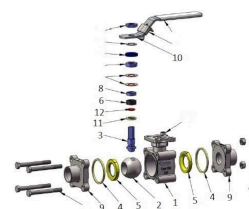

## Measurements and weight

**Dimension range (DN):** 10 - 50

DN	A	B	C	D	F	G	Net weight (kg)
15	75	76.6	140	42.6	15	24.5	0.9
20	86	81.7	140	46.8	20	31.4	1.4
25	106	98.3	170	59.3	25	41.3	2.1
32	111	101.6	170	62.6	32	48.4	2.9
40	130	128	230	79	38	56.3	4.4
50	143	137	230	87.7	50	71.4	4.5

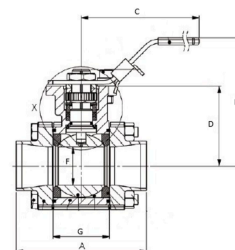

## Function and design

Three-piece ball valve for easy service and maintenance.  
 Homogeneous liquid ball for tight shut-off and low pressure drop.  
 Self-compensating spindle packing provides a tight valve at high operating frequencies.  
 Blow-out safe antistatic spindle construction prevents the spindle from being pushed out during pressure surges.  
 Mounting flange according to ISO 5211 for actuators.  
 No valve disassembly required for service and installation of actuators.  
 Valves larger than DN50 have a round valve body/mounting flange.

## Technical data

**Main material:** Steel  
**Main material code:** Steel GP240GH N (1.0619)  
**Included materials:** Stainless steel, Steel, Other  
**Included material code:** Acid resistant stainless steel AISI 316 (1.4401), Steel GP240GH N (1.0619), Carbon filled PTFE  
**Temperature (°C):** -28 - 220  
**PN:** 64 - 125  
**Connection:** Internal thread ISO 228-1 (G, BSPP)  
**ETIM classification:** EC011343 - Ball valve  
**BK04 code:** 20702 Ball valves  
**Comment to colour:** Black

Item number	KVS	Execution	Connection 1	Connection 1 - spec.	Connection 2	Connection 2 - spec.	Connection according to ISO 5211	Stem measurements
3565-15	12.7	Full bore	Internal thread ISO 228-1 (G, BSPP)	1/2	Internal thread ISO 228-1 (G, BSPP)	1/2	F03/F04	9x9mm
3565-15PK	12.7	Full bore	Internal thread ISO 228-1 (G, BSPP)	1/2	Internal thread ISO 228-1 (G, BSPP)	1/2	F03/F04	9x9mm
3565-20	29.2	Full bore	Internal thread ISO 228-1 (G, BSPP)	3/4	Internal thread ISO 228-1 (G, BSPP)	3/4	F03/F04	9x9mm
3565-25	48.2	Full bore	Internal thread ISO 228-1 (G, BSPP)	1	Internal thread ISO 228-1 (G, BSPP)	1	F04/F05	11x11mm
3565-32	73.1	Full bore	Internal thread ISO 228-1 (G, BSPP)	1 1/4	Internal thread ISO 228-1 (G, BSPP)	1 1/4	F04/F05	11x11mm
3565-40	107.5	Full bore	Internal thread ISO 228-1 (G, BSPP)	1 1/2	Internal thread ISO 228-1 (G, BSPP)	1 1/2	F05/F07	14x14mm
3565-50	215	Full bore	Internal thread ISO 228-1 (G, BSPP)	2	Internal thread ISO 228-1 (G, BSPP)	2	F05/F07	14x14mm

## Installation and maintenance

**Flowdirection:** Bi-directional

**Possible mounting position:** Vertical, Horizontal

The valve should be regularly exercised to avoid the accumulation of dirt that can lead to leakage.

The company's management system  
is certified by DNV  
ISO 9001 • ISO 14001

# Get into the flow

Get into the flow with Armatec.



**armatec**

info@armatec.se | +46 31 89 01 00 | www.armatec.se