

Ball valve AT 3540-

PRESTERA™



Product information

Ball valve with reduced flow of steel/CPTFE with welded ends and mounting flange for actuator. Suitable for automation. Three-piece for easy service and maintenance. Primarily for steam, gas, hot and cold water.

Dimension range (DN)	15 - 100
PN	64 - 125
Temperature (°C)	-28 - 220
Main material	Steel

Area of use

Shut-off valve primarily for:

- Petroleum products
- Hot and cold water as well as compressed air
- Saturated steam

Tender text

PSB.1 Ball valves

Steel ball valve AT 3540... with reduced flow, welded ends, and hand lever in stainless steel. Packing made of carbon-filled PTFE.

Quality assurance

AFS 2023:5, PED 2014/68/EU

The product is CE marked

The valves meet the requirements of PED, AFS 2016:1, the directive for pressure-bearing devices, according to category III, fluid group 1 and 2. Dimensions up to DN 25 comply with §8 in PED, AFS 2016:1. CE/PED 97/23/EG.

Product marking: Manufacturer, DN, PN, material code, CE. If applicable, also flow direction. QR code.

Energy and environment declaration

Subject to notification under REACH: No

Reach date: 16/04/2026

Pos **Component** **Material**

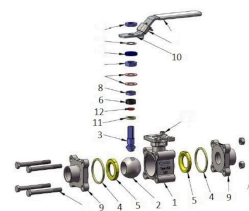

Measurements and weight

Dimension range (DN): 15 - 100

3540-

DN	A	B	C	D	F	G	Net weight (kg)
15	75	76.6	140	42.6	10	24.5	0.9
20	75	76.6	140	42.6	15	24.5	0.9
25	90	81.7	140	46.8	20	31.4	1.4
32	110	98.3	170	59.3	25	41.3	2.2
40	115	101.6	170	62.6	32	48.4	3.5
50	130	128	230	79	38	56.3	2.9
65	143	137	230	87.7	50	71.4	7.2
80	185	167.5	380	108.7	65	86.6	13
100	205	176.5	520	117.7	80	99	17.8

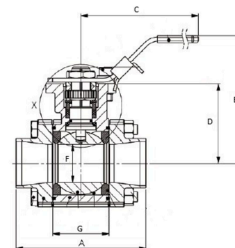

Function and design

Three-piece ball valve for easy service and maintenance.
 Homogeneous liquid ball for tight shut-off and low pressure drop.
 Self-compensating spindle packing provides a tight valve at high operating frequencies.
 Blow-out safe antistatic spindle construction prevents the spindle from being pushed out during pressure surges.
 Mounting flange according to ISO 5211 for actuators.
 No valve disassembly required for service and installation of actuators.
 Valves larger than DN50 have a round valve body/mounting flange.

Technical data

Main material: Steel

Main material code: Steel GP240GH N (1.0619)

Included materials: Stainless steel, Steel, Other

Included material code: Acid resistant stainless steel AISI 316 (1.4401), Steel GP240GH N (1.0619), PTFE (polytetrafluoroethylene), Carbon filled PTFE

Temperature (°C): -28 - 220

PN: 64 - 125

Connection: ASTM A53, Schedule 40

ETIM classification: EC011343 - Ball valve

BK04 code: 20702 Ball valves

Comment to colour: Black

Item number	KVS	Execution	Connection 1	Connection 1 - spec.	Connection 2	Connection 2 - spec.	Connection according to ISO 5211	Stem measurements
3540-15	6.9	Reduced bore	ASTM A53, Schedule 40	DN15-Dy 21,7mm	ASTM A53, Schedule 40	DN15-Dy 21,7mm	F03/F04	9x9mm
3540-20	12.7	Reduced bore	ASTM A53, Schedule 40	DN20-Dy 27,2mm	ASTM A53, Schedule 40	DN20-Dy 27,2mm	F03/F04	9x9mm
3540-25	29.2	Reduced bore	ASTM A53, Schedule 40	DN25-Dy 34mm	ASTM A53, Schedule 40	DN25-Dy 34mm	F03/F04	9x9mm
3540-32	48.2	Reduced bore	ASTM A53, Schedule 40	DN32-Dy 42,7mm	ASTM A53, Schedule 40	DN32-Dy 42,7mm	F04/F05	11x11mm
3540-40	73.1	Reduced bore	ASTM A53, Schedule 40	DN40-Dy 48,6mm	ASTM A53, Schedule 40	DN40-Dy 48,6mm	F04/F05	11x11mm
3540-50	107.5	Reduced bore	ASTM A53, Schedule 40	DN50-Dy 60,5mm	ASTM A53, Schedule 40	DN50-Dy 60,5mm	F05/F07	14x14mm
3540-65	215	Reduced bore	ASTM A53, Schedule 40	DN65-Dy 76,6mm	ASTM A53, Schedule 40	DN65-Dy 76,6mm	F05/F07	14x14mm
3540-80	275.2	Reduced bore	ASTM A53, Schedule 40	DN80-Dy 88,9mm	ASTM A53, Schedule 40	DN80-Dy 88,9mm	F07/F10	17x17mm
3540-100	498.8	Reduced bore	ASTM A53, Schedule 40	DN100-Dy 114,3mm	ASTM A53, Schedule 40	DN100-Dy 114,3mm	F07/F10	17x17mm
3540-20PK	12.7	Reduced bore	ASTM A53, Schedule 40	DN20-Dy 27,2mm	ASTM A53, Schedule 40	DN20-Dy 27,2mm	F03/F04	9x9mm
3540-25PK	29.2	Reduced bore	ASTM A53, Schedule 40	DN25-Dy 34mm	ASTM A53, Schedule 40	DN25-Dy 34mm	F03/F04	9x9mm
3540-32PK	48.2	Reduced bore	ASTM A53, Schedule 40	DN32-Dy 42,7mm	ASTM A53, Schedule 40	DN32-Dy 42,7mm	F04/F05	11x11mm

Installation and maintenance

Flowdirection: Bi-directional

Possible mounting position: Vertical, Horizontal

See separate manual. The valve should be operated regularly to avoid the accumulation of dirt that can lead to leakage.

The company's management system
is certified by DNV
ISO 9001 • ISO 14001

Get into the flow

Get into the flow with Armatec.



armatec

info@armatec.se | +46 31 89 01 00 | www.armatec.se