

Globe valve AT 1040CX



Product information

Cone valve made of stainless acid-resistant steel, with flanges, PN 40. With rising, externally threaded spindle. Flat sealing surfaces. The packing box is pressure-relieved with the cone in the fully open position. Valves from DN 125 have a pressure-relieved cone as standard, which also means that the flow direction is from the opposite direction, i.e. from top to bottom. Used as a shut-off valve for steam, condensate, hot water.

Dimension range (DN)	15 - 250
PN	40
Temperature (°C)	-10 - 400
Main material	Stainless steel

Area of use

As shut-off valve for:

- steam
- hot water
- condensate

Tender text

PSB.5 Ball valves and needle valves

Quality assurance

AFS 2023:5, PED 2014/68/EU

The product is CE marked

Product marking: Manufacturer, DN, PN, material, and arrow indicating flow direction.

Energy and environment declaration

Reach date: 12/3/2024 1:06:00 PM

Reach note: The product is not covered by REACH

List of details

Pos	Component	Material
1	Body	Acid resistant stainless steel AISI 316 (1.4408, CF8M)
2	Bonnet	Acid resistant stainless steel AISI 316 (1.4408, CF8M)
3	Seat	Acid resistant stainless steel AISI 316 (1.4408, CF8M)
4	Globe	Acid resistant stainless steel AISI 316 (1.4408, CF8M)
5	Spindle	Acid resistant stainless steel AISI 316 (1.4401)

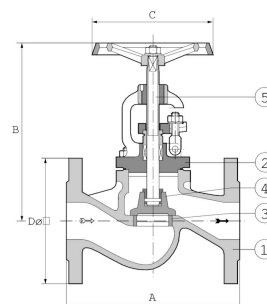

Measurements and weight

Dimension range (DN): 15 - 250

Item number	A	B	C	D	Net weight (kg)
1040CX15	130	185	140	95	4.5
1040CX20	150	185	140	105	5.5
1040CX25	160	220	160	115	7
1040CX32	180	220	160	140	8
1040CX50	230	255	180	165	13.5
1040CX65	290	300	225	185	19
1040CX80	310	335	250	200	27
1040CX80-16	310	335	250	200	27
1040CX100	350	370	300	235	40.5
1040CX100-16	350	370	300	220	40.5

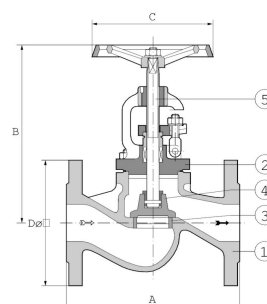

Function and design

Rising, externally threaded spindle. Flat sealing surfaces.
The packing box is pressure relieved with the cone in fully open position.

Maximum working pressure and temperature:

35 bar at 200°C

28 bar at 300°C

21 bar at 400°C.

Technical data

Main material: Stainless steel

Main material code: Acid resistant stainless steel AISI 316 (1.4408, CF8M)

Included materials: Stainless steel

Included material code: Acid resistant stainless steel AISI 316 (1.4401), Acid resistant stainless steel AISI 316 (1.4408, CF8M)

Temperature (°C): -10 - 400

Temperature notes: DIN EN 1092 determines the allowable operating pressure in relation to temperature.

Maximum 35 bar at 200°C, maximum 28 bar at 300°C, maximum 21 bar at 400°C.

PN: 40

Connection: Flanged EN1092

ETIM classification: EC010120 - Globe valve

ProductColourAndColourNote: .

DN	15	20	25	32	50	65	80	100
KVS	4.8	7.3	9.6	17.8	40.1	70.1	111	172

Installation and maintenance

Flowdirection: Uni-directional

Possible mounting position: Vertical, Horizontal

Can be installed in any built-in position. Exception: downward-facing valve.

The system is flushed before commissioning.

Valves DN15-100 have a flow direction from bottom to top (under the cone).

Valves DN125-250 have the opposite flow direction, i.e. from top to bottom.

However, the flow direction is always indicated by an arrow on the valve housing.

The company's management system
is certified by DNV
ISO 9001 • ISO 14001

Get into the flow

Get into the flow with Armatec.



armatec

info@armatec.se | +46 31 89 01 00 | www.armatec.se