

Balancing Valve

with bellows

AT 1356A, 1357A

Dimension range DN 15 - 150	PN 40	Temperature range max 400°C	Material Steel Stainless steel
---------------------------------------	-----------------	---------------------------------------	---

Range of Application

As balancing valve mainly for:

Steam
Thermal oil
Condensate
Hazardous fluids
Hot water

Quality Assurance

Pressurized parts are manufactured in a factory which generally is approved by all recognised classification authorities.

Testing is carried out according to SS-ISO 5208. Leakage class 1 and applies to the valve type.

Certificate, SS-EN 10204 type 2.2, 3.1 and from most off the classification authorities, type of certificate has to be specified upon ordering.

CE-marking

Fulfil PED 97/23/EC acc. to category III group 1 and 2.

Material Specification

DN	AT 1356A			AT 1357A	
		15-50	65-150	15-150	
1	Body	steel	1.04060	1.0619/1.0305	1.4581/1.4571 (stainless)
2	Seat	stainless steel	1.4370	1.4370	Stellite 21
3	Globe	stainless steel	1.4021	1.4021	1.4571/Stellite 6
4	Bellows	stainless steel	1.4571	1.4571	1.4571
5	Stem	stainless steel	1.4122	1.4122	1.4571

Dimension and Weight

DN	15	20	25	32	40	50	65	80	100	125	150
A	130	130	130	160	180	210	290	310	350	400	480
B	220	220	220	270	270	300	370	460	470	510	820
C	120	120	120	150	150	175	175	200	250	300	400
Dy	21,3	26,9	33,7	42,4	48,3	60,3	76,1	88,9	114,3	139,7	168,3
Weight	6,0	6,0	7,0	8,5	8,5	13,0	11,0	25,0	32,0	36,0	101,0

Measurements in mm, weight in mm.

Function and Design

The bellows seal (4) prevents the fluid from coming in contact with the stuffing box. This eliminates the risk of leakage from the stuffing box.

Maintenance free
Conical sealing orifices
External stem threads
Position indicator open/closed
Rising hand wheel
Lockable length of stroke

Technical Information

Pressure and temperature

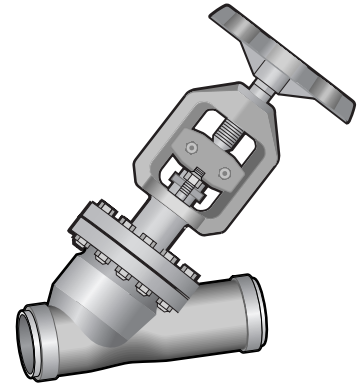

AT 1356A

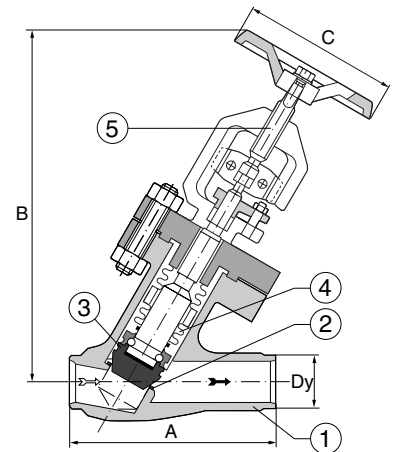

Balancing Valve

with bellows

AT 1356A, 1357A

Acc. to DIN 1092 with following maximum value:

Fig. no.	Working press. max. bar	Working temp. max. °C
AT 1356A, 1357A	40	120
	35	200
	28	300
	21	400

Pressure drop

To calculate pressure drop following value is to be used.

DN	15	20	25	32	40	50	65	80	100	125	150
K _{vs}	7	11	16	26	40	69	111	153	224	367	538

Relief globe

In order to facilitate the operation and give a good tightness the valve shall be provided with a relief globe at a differential pressure higher than following.

DN	150
Δp bar	17

Accessories and Options

Pneumatic actuator.

Larger dimensions on request.

Installation

Weld ends acc. to SS1240*.

The valve can be mounted in optional position. Exception: downward hand wheel.

* *Welding in method:* Gas welding should be avoided to avoid risks of cracks, At welding in the valve shall be in full closed position. The system shall be flushed clean before put into service.

Maintenance and Spare Parts

At time for put into service the pin joint house/cover shall be after drafted. Otherwise the valve is maintenance free.

Marking

Manufacturer, DN, PN, material and flow arrow.

How to order

Example: AT 1356A50	
AT 1356A	50
Fig.no.	DN
AT 1356A = Steel	DN 15-150
AT 1357A=Stainless steel	DN 15-150

Rätten till ändringar utan föregående meddelande förbehålls.
Armatec ansvarar inte för eventuella tryckfel eller missförstånd.
Dokumentet får kopieras endast i sin helhet.