

Ball Valve

Extended butt weld ends

AT 3502W, 3502WP, 3507WP

Dimension range	PN	Temperature range	Material
DN 8-100	10/100	-20 - 200 °C	Accid prof stainless steel

Range of Application

- As shut off valve with weld ends mainly for applications within:
- Pharmacy
- Biotechnology
- Photomechanical industry
- Cosmetics
- Microchips manufacturing
- Food industry
- Orbital welding

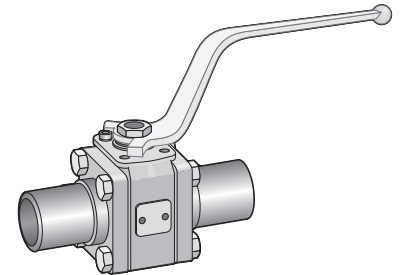

AT 3502W

Quality Assurance

Testing is carried out according to SS-ISO 5208 leakage class 3 and applies to the valve type.

Certificate SS-EN 10204, type 2.2 and 3.1B, type of certificate has to be specified upon ordering.

CE-marking

Fulfill PED 97/23/EC acc. to category III group 1 and 2

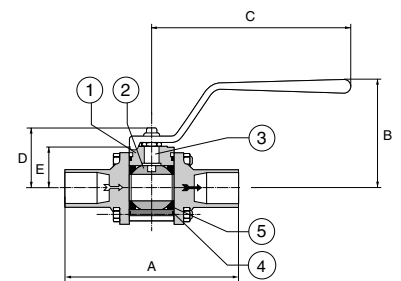

Material Specification

			AT 3502W		AT 3507WP	
			AT 3502WP			
1	Body	stainless steel	DN 8-32	X2CrNiMo18.10	DN 8-25	X2CrNiMo18.10
		stainless steel	DN 40-50	G-X6CrNiMo18.10	DN 32-50	G-X6CrNiMo18.10
2	Ball	stainless steel	DN 8-50	X2CrNiMo18.10	DN 8-40	X2CrNiMo18.10
		stainless steel			DN 50	G-X6CrNiMo18.10
3	Stem	stainless steel		X2CrNiMo18.10		X2CrNiMo18.10
4	Body gasket			PTFE		PTFE
5	Seat ring*			PTFE		PTFE

* Seat in high temperature performance, carbon-filled (25%) PTFE, additional designation HT. Seat rings in different material on request. for example PTFE glass reinforced and PEEK.

Dimension and Weight

AT 3502W, 3502WP					
DN	15	20	25	40	50
A	105	112,5	125,4	150,4	166,3
B	93	96	96	116	124
C	140	140	180	200	200
D	40	42	53	71	76
E	30	32	38	42	46
F	11,1	14,2	20,6	31,7	38
Weight	0,5	0,8	1,4	3,0	4,0

Measurement in mm. weight in kg. Top flange acc. to. ISO measurements, see data sheet AT3502 .

Ball Valve

Extended butt weld ends

AT 3502W, 3502WP, 3507WP

AT 3507W						
DN	8/10	15	20	25	40	50
A	105	122	125	139	166	197
B	93	96	96	115	140	157
C	140	140	180	180	200	250
D	39,5	42	53	58	75,5	86
E	30	32	38	36	46,5	70
F	11,1	14,2	20,6	25,4	38	50
Weight	0,5	0,8	1,4	1,9	4,0	6,8

Measurement in mm. weight in kg. Top flange acc. to. ISO measurements, see data sheet AT3507 .

Function and Design

3-piece ball valve for orbital welding without disassembling the valve. With homogenous floating ball for tight shut-off at pressure as well as vacuum. Antistatic self-compensating stem packing eliminates leakage to and from atmosphere.

The design with blow-out safe stem prevents the stem to blow out at pressure hammer.

With normal surface finish or polished. Mechanical and/or electro polished to meet a high grade of cleanness. Polished valves have a surface finish of max. RA 0,8 μ . Better surface finish on request.

The valves are also suitable for welding if extended ends acc. to to some special pipe dimension is requested.

Technical Information

Fig. no.	AT 3502W	AT 3502WP	AT 3507WP
DN	15-50	15-50	8-50
Bore	reduced	reduced	full
Surface finish	normal	internal polished Ra 0,8	internal polished Ra 0,8

Standard performance

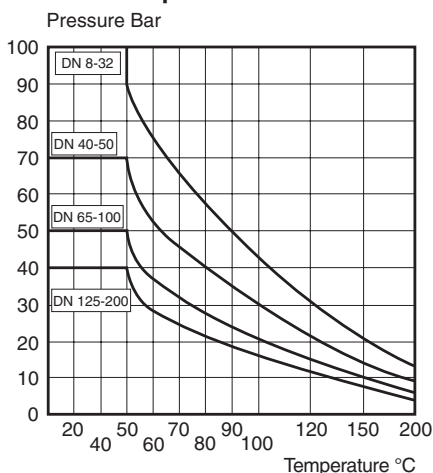

High temperature performance

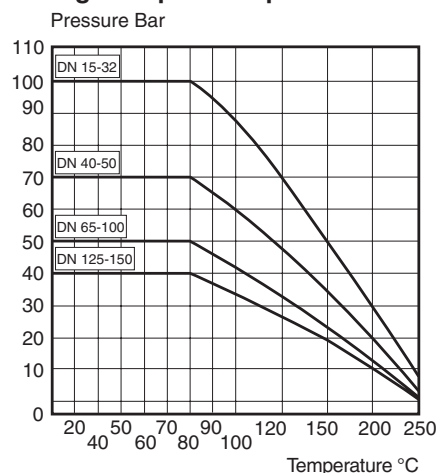

Rätten till ändringar utan föregående meddelande förbehålls.
 Armatec ansvarar inte för eventuella tryckfel eller missförstånd.
 Dokumentet får kopieras endast i sin helhet.

Ball Valve

Extended butt weld ends

AT 3502W, 3502WP, 3507WP

DN	Working pressuer max. bar			
	8-25	32	40	50
AT 3502W	100	100	70	70
AT 3502WP	100	100	70	70
AT 3507WP	100	70	70	50

Max. working temperature 200°C related to standard valves. See pressure/temperature chart above.

DN	ISO 1127	DIN 11850			SMS 308
	Series 1	Series 1	2	3	
8	13,5*1,6	-	-	-	-
10	17,2*1,6	12,0*1,0	13,0*1,5	14,0*2,0	-
15	21,3*1,6	18,0*1,0	19,0*1,5	30,0*2,0	12,0*1,0
20	26,6*1,6	22,0*1,0	23,0*1,5	24,0*2,0	18,0*1,0
25	33,7*2,0	28,0*1,0	29,0*1,5	20,0*2,0	25,0*1,2
32	42,4*2,0	34,0*1,0	35,0*1,5	36,0*2,0	33,7*1,2
40	48,3*2,0	40,0*1,0	41,0*1,5	42,0*2,0	38,0*1,2
50	60,3*2,0	52,0*1,0	53,0*1,5	54,0*2,0	51,0*1,2

DN	Torque (Nm)						
	8/10	15	20	25	32	40	50
3502W, 3502WP	-	4	5	9	15	20	25
3507WP	4	5	9	15	20	25	50

DN	Kv-value						
	8/10	15	20	25	32	40	50
3502W, 3502WP	-	8	13	30	48	80	120
3507WP	8	20	40	75	80	170	270

Accessories and Options

Can be provided with different types of actuators and limit switches, see separate datasheet.

The valve is available with different types of accessories and in different performance as stem extension, cavity filling, spring return handle with spring-to-open or spring-to-close function.

Fire-safe design, 3-way valves, heating jacket, Cryo performance, double stuffing box and tank bottom valve.

On request the valve is also available with other in- and outside surface finish and with different length of the weld ends.

Installation

Valves with weld ends can be welded in without disassembling and are also suitable to be welded in with the so-called Orbital-method.

Maintenance and Spare parts

The 3-piece valve design admit a simple exchanging of all parts accept the weld end pieces.

Ball Valve

Extended butt weld ends

AT 3502W, 3502WP, 3507WP

Marking

Manufacturer, DN, PN and material.

How to order

Exempel: AT 3502WP250X12-25				
AT 35	02	WP	250x12	25
Fig. no.	02 = Reduced bore 07 = Full bore	performance W = weld ends 30mm P = Max Ra 0,8 μ	Outside diam. x material thicknes	DN